

*Lyfco*®

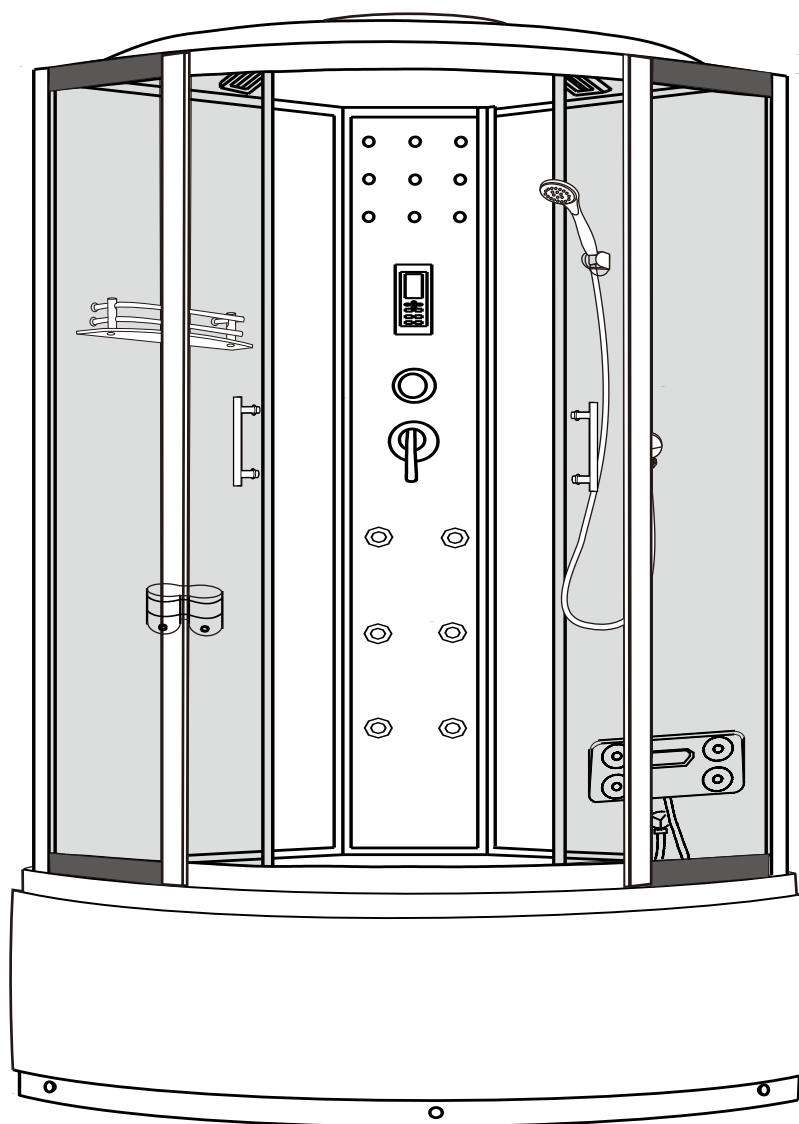

BK-022  
1000X1000X2180mm

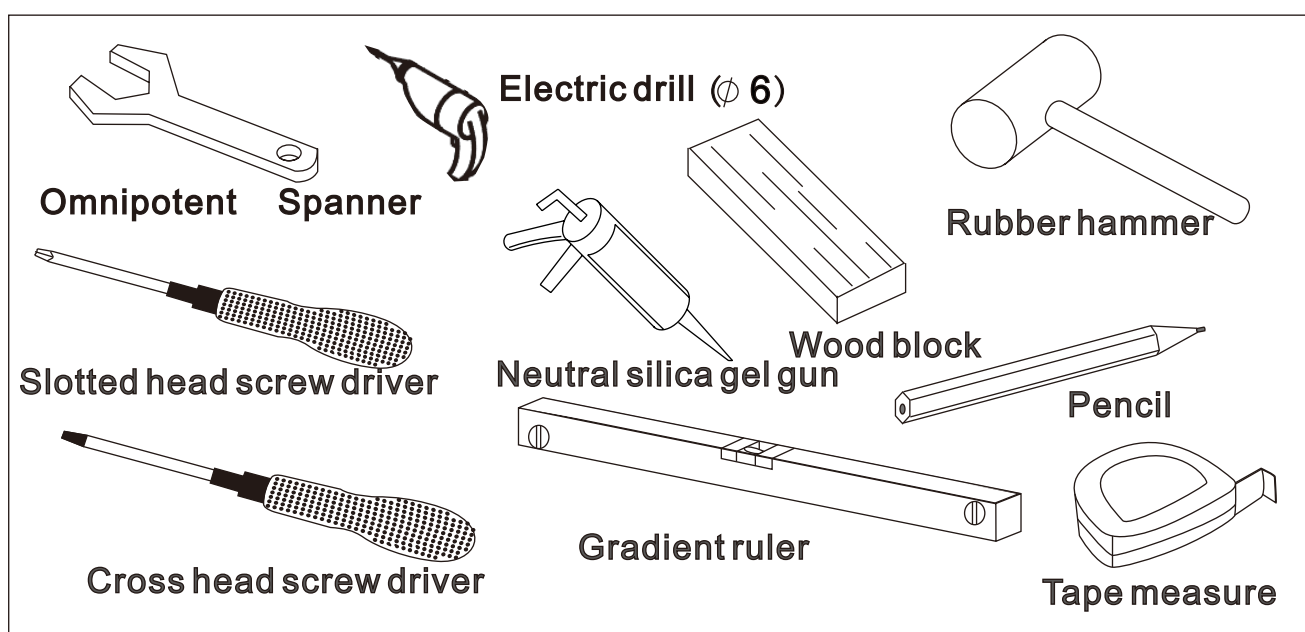

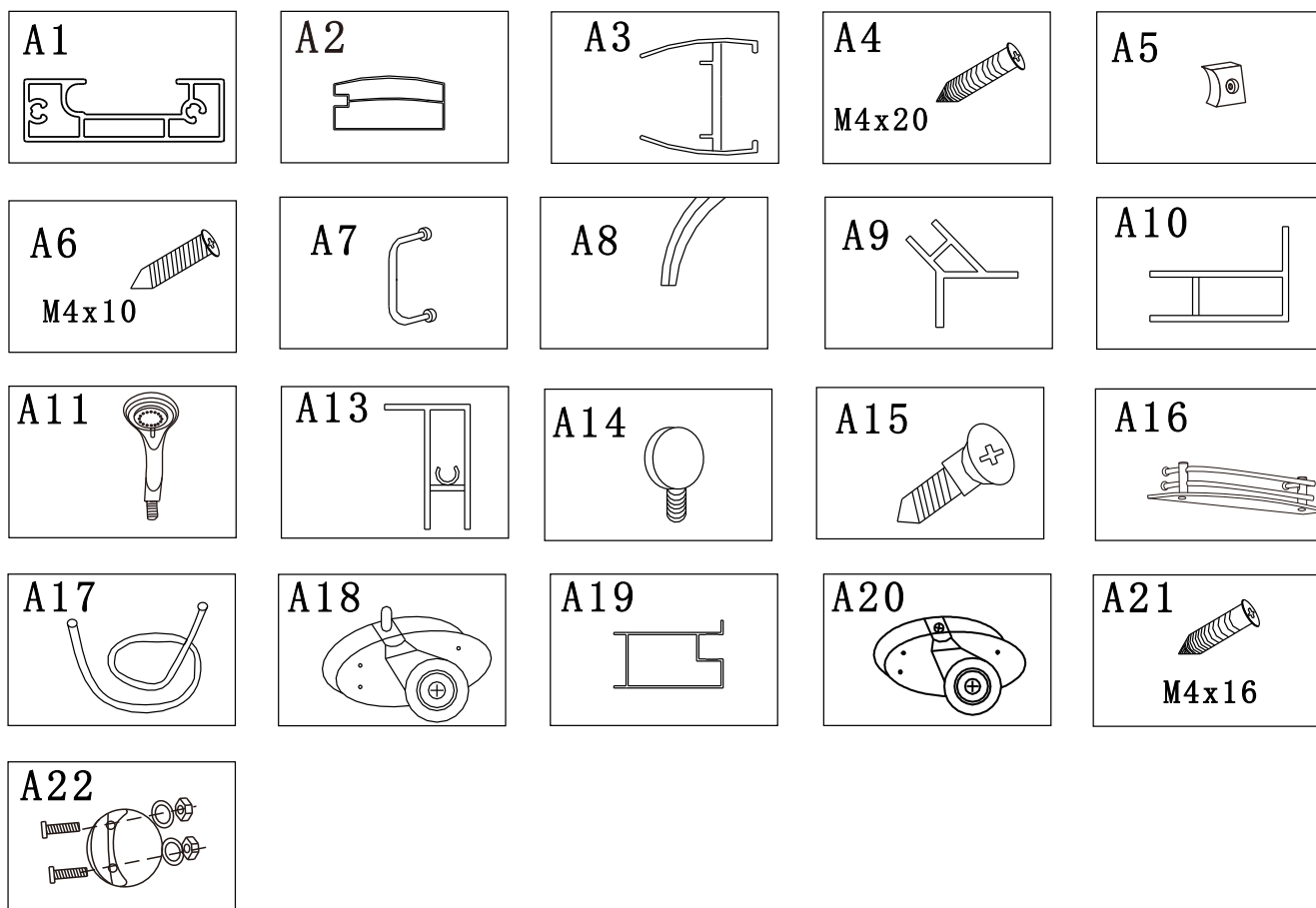
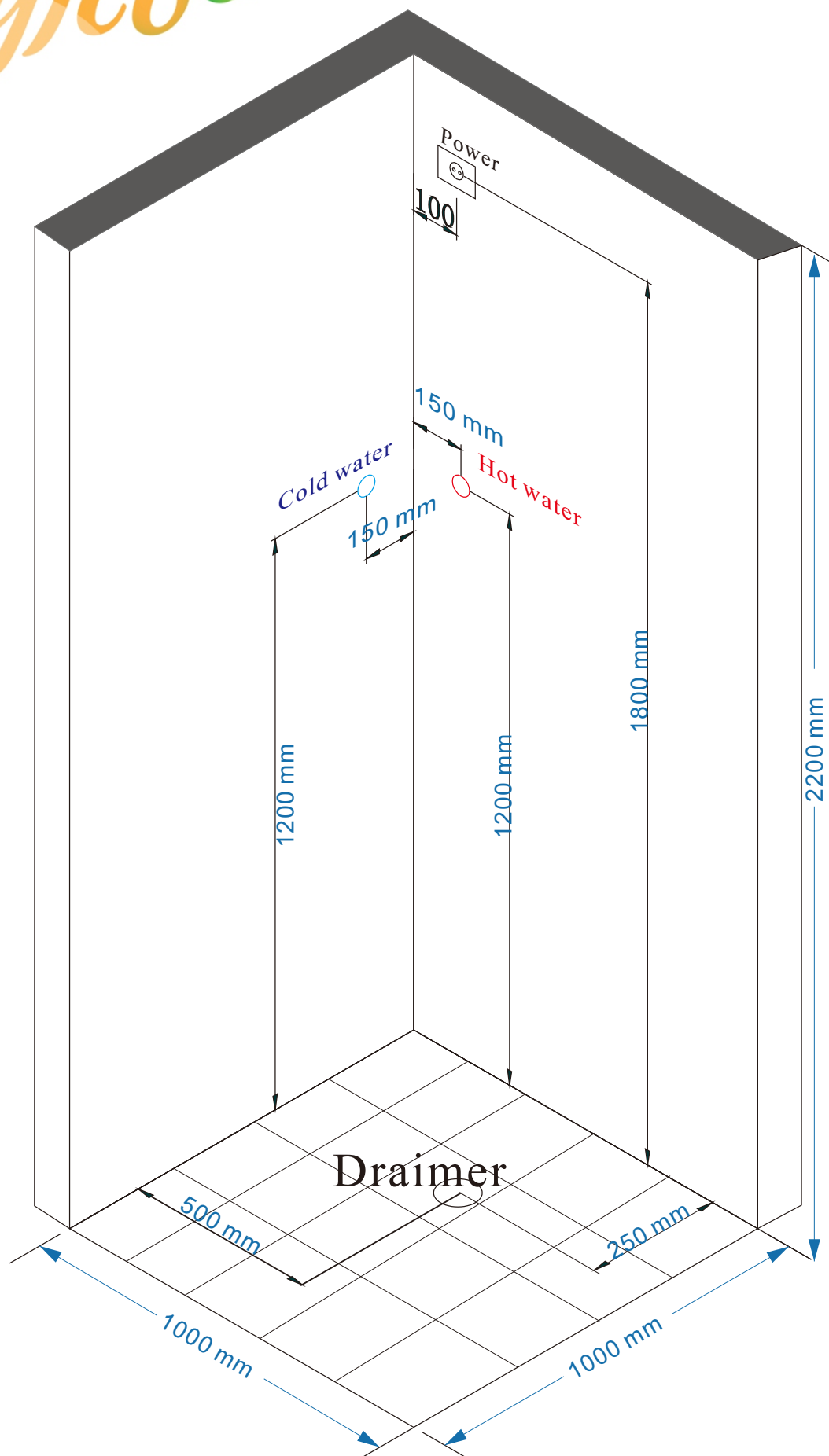

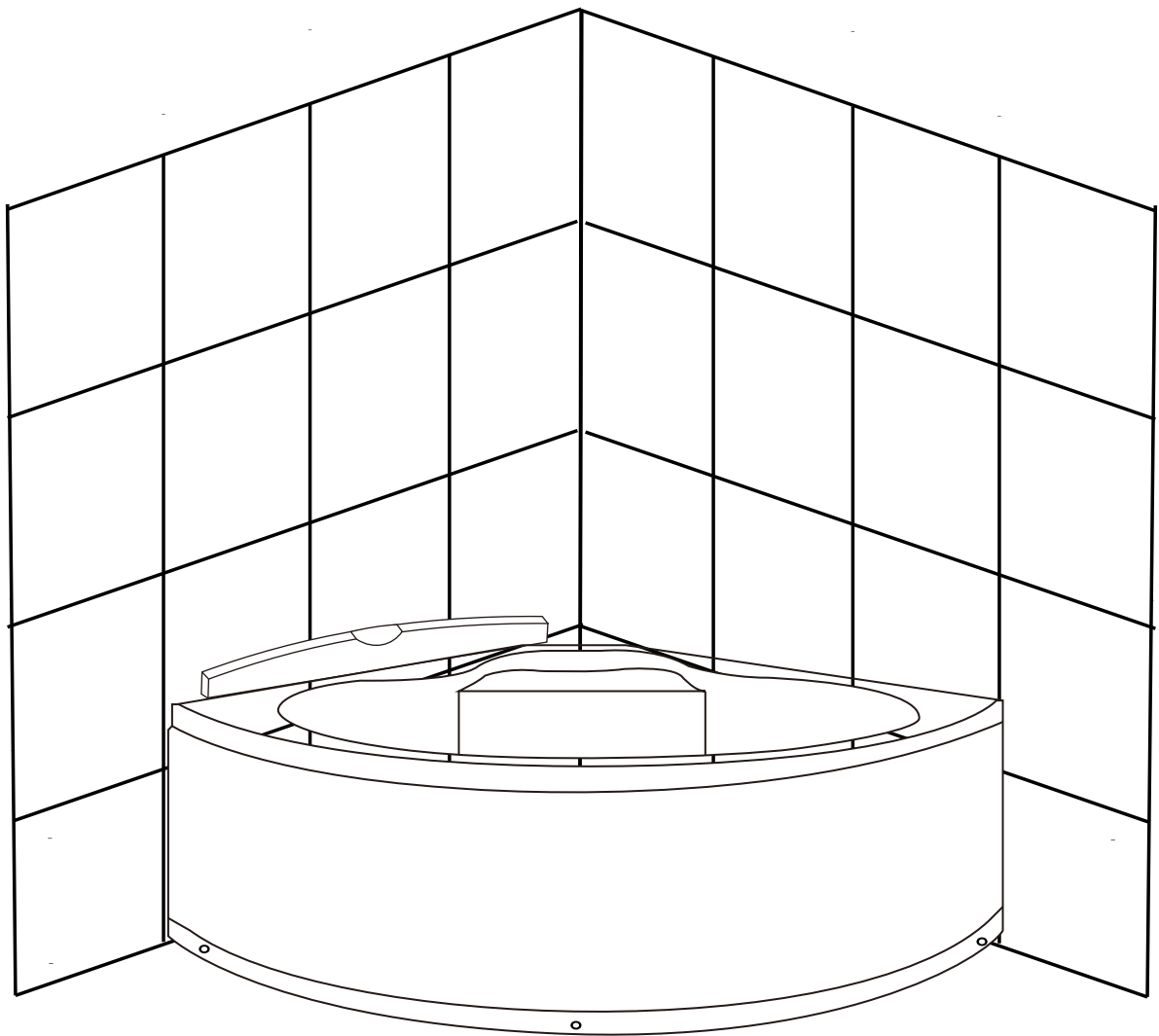
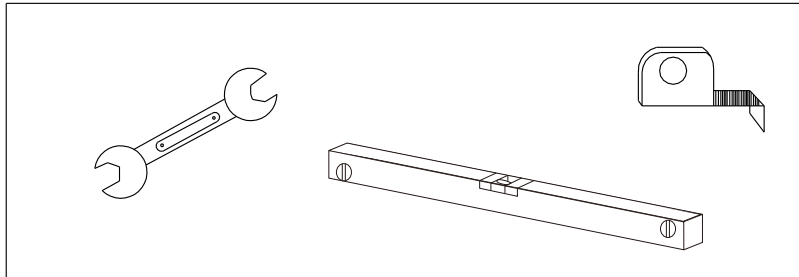

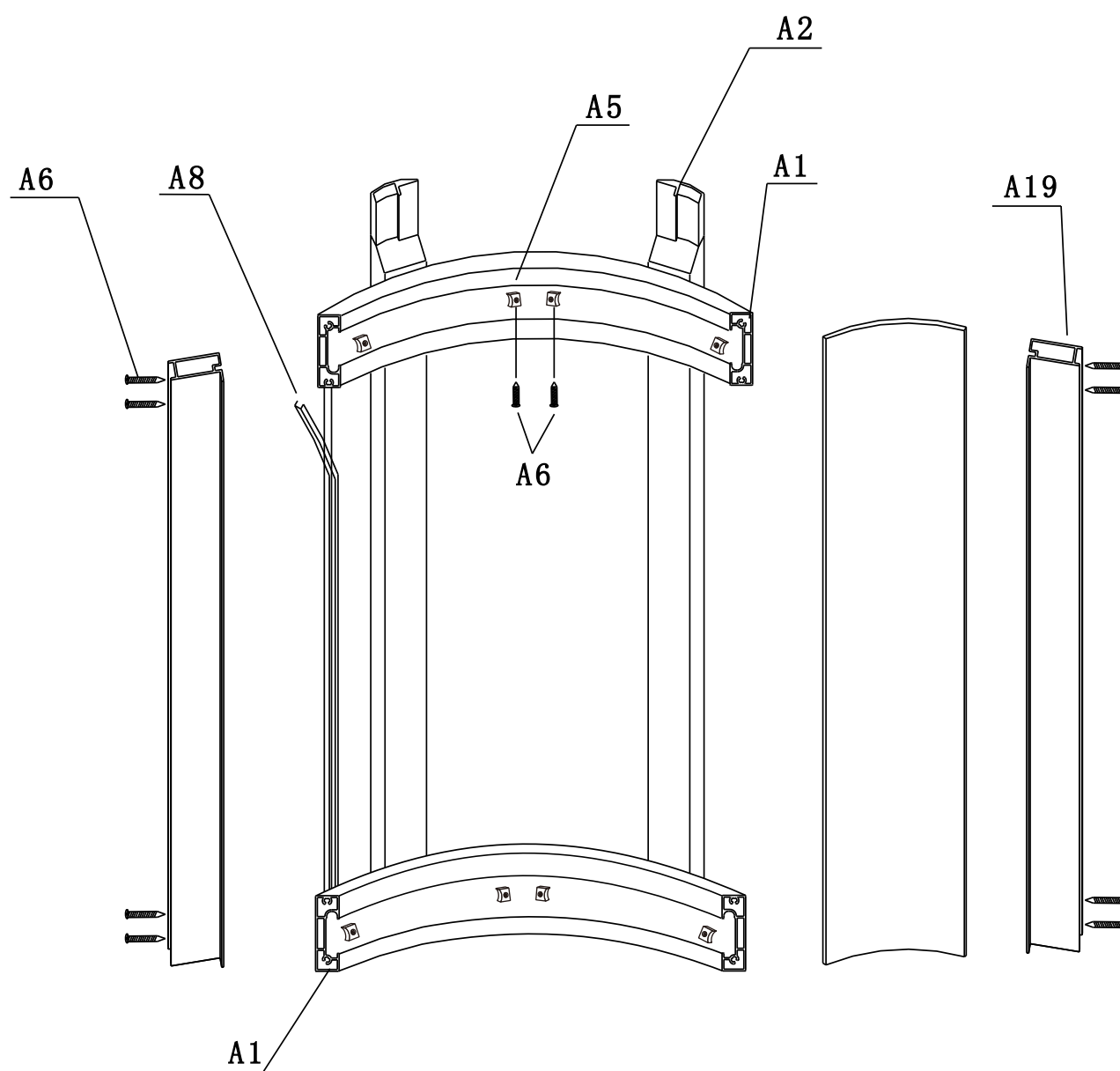
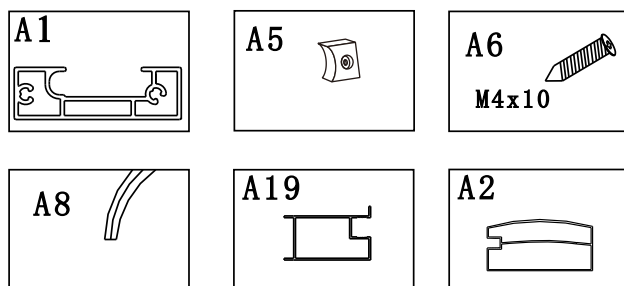

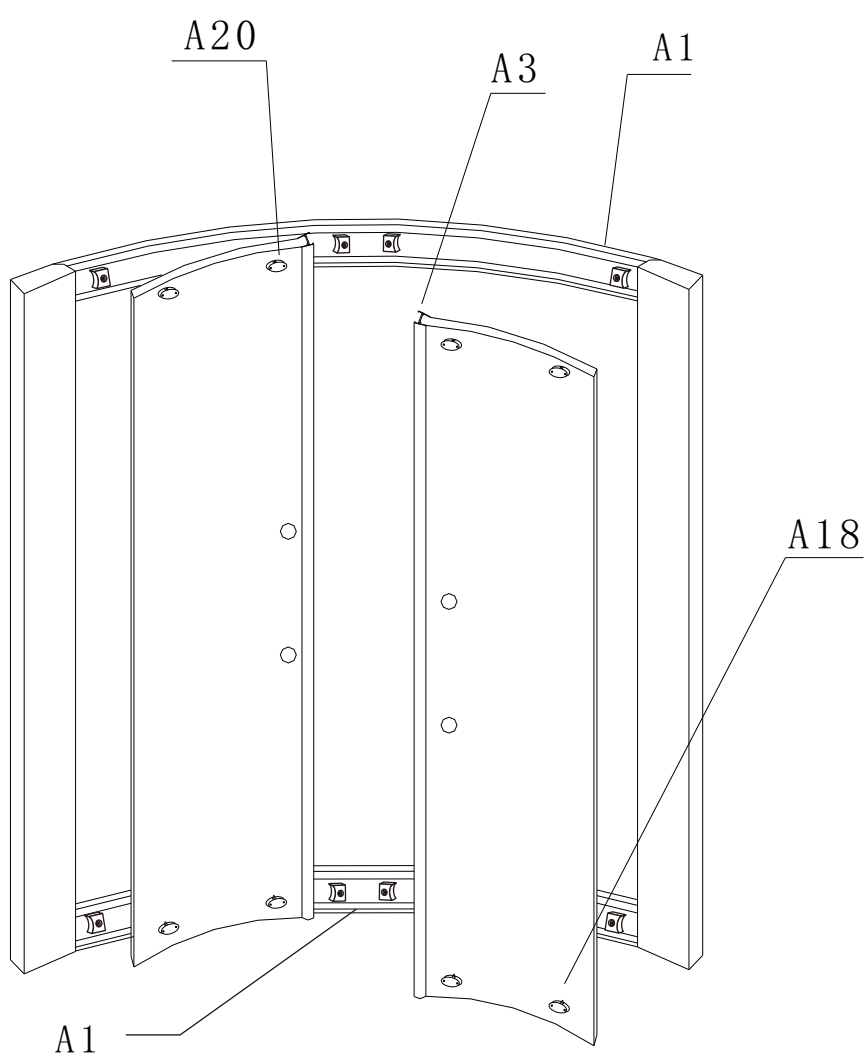
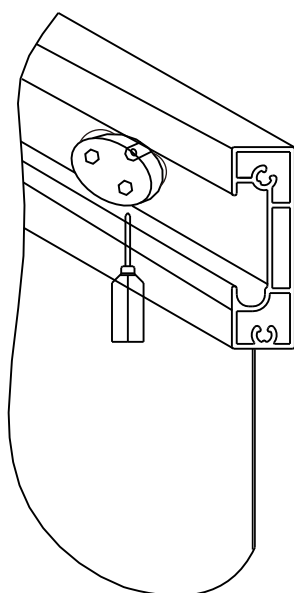
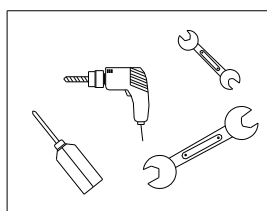
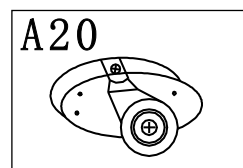
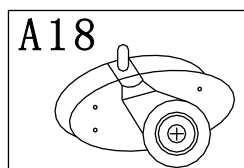
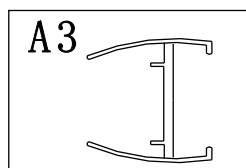
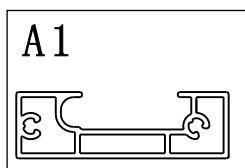

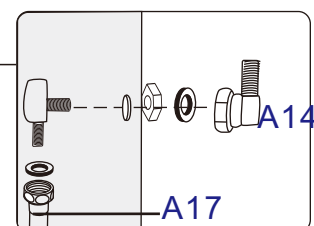
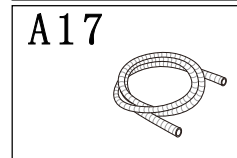
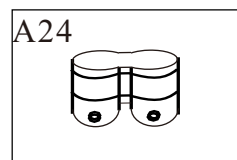
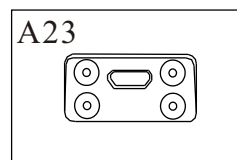
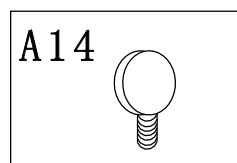
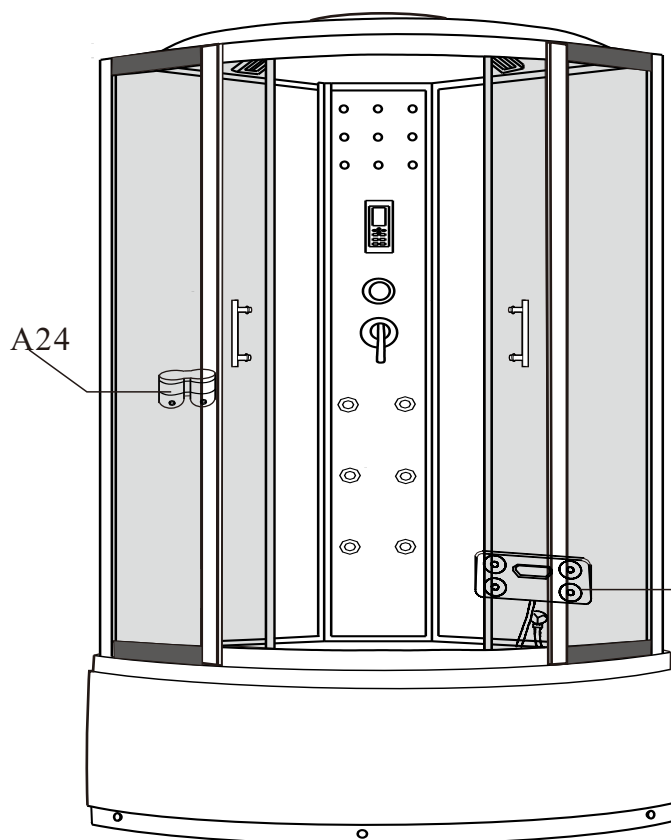
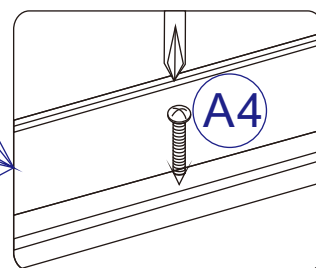
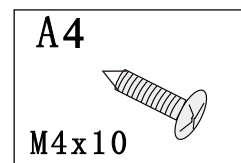
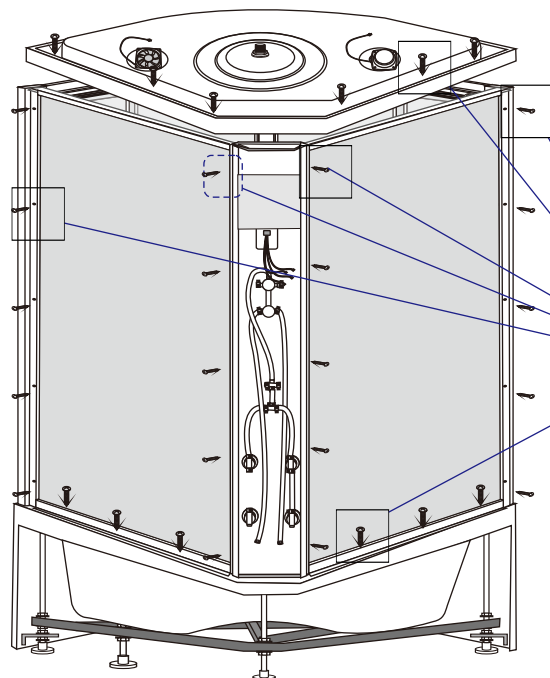

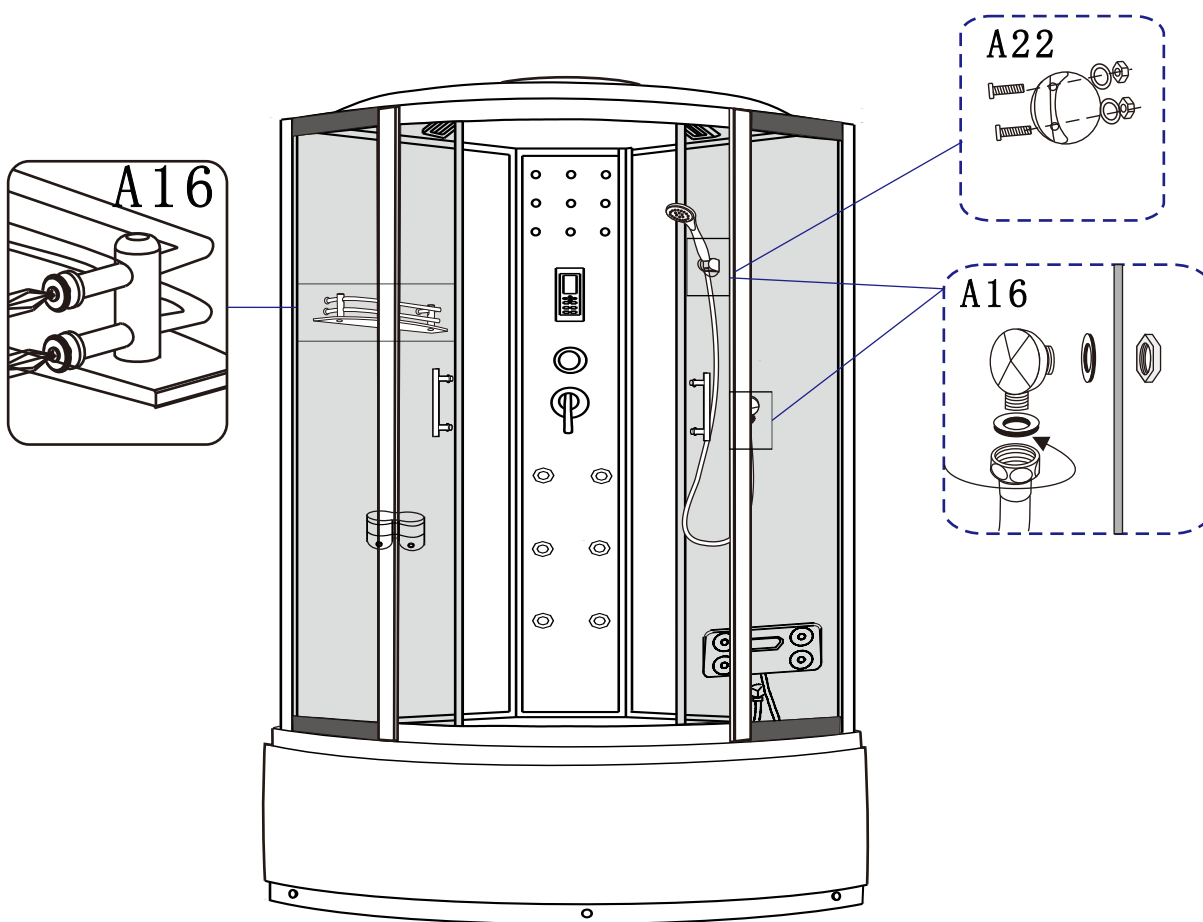
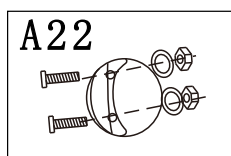
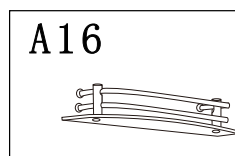

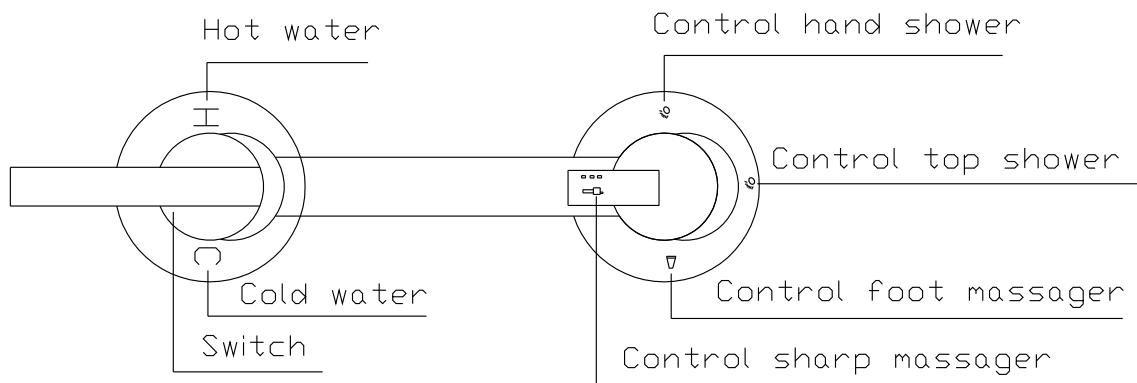

#### Using instruction for shower room

- 1, Open the switch, it can be adjusted the hot and cold water by turning into right and left side, it is fine when you feel temperature is ok.
- 2, Turning the adjuster, it can control water running from the hand shower, foot massager, sharp massager and top shower.
- 3, The hydraulic pressure is 0.4Mpa in every part.
- 4, Please turn off the power and switch of the shower room after used it.
- 5, The glass of shower room is high-quality tempered glass, please don't impact it.

